



SG | 
ENTERPRISES

BUILDING A **STRONG** NATION



**PIPES & PIPES FITTINGS ELBOWS | VALVES | FLANGES
NUT & BOLT | TEES | REDUCERS | GASKETS**



ABOUT US....



At SG Enterprises, we specialise in the efficient and reliable distribution of a wide range of Pipes & Pipe Fittings in MS ERW, GI, Seamless & Stainless Steel to retail stores and directly to consumers. With years of experience in the industry, we have built a reputation for excellence in customer service and logistics management.

Our state-of-the-art warehouse and distribution centre in Vishakhapatnam is strategically located to enable efficient transportation and delivery of goods to customers. Equipped with the latest technology and staffed by experienced professionals, we ensure that all products are handled and processed with the utmost care and attention to detail.

We offer a range of value-added services to our customers, including packaging and inventory management. Our team of experts works closely with our customers to understand their unique needs and requirements, and we tailor our services accordingly to ensure that we provide the most efficient and effective distribution solutions.

We are committed to providing the highest level of customer service, with a focus on timely and reliable delivery of products. Our team is always available to answer questions and provide support, and we work closely with our customers to ensure that their products are delivered on time and in perfect condition.

Overall, SG Enterprises is dedicated to providing the best possible service to our customers, with a focus on quality, efficiency, and reliability. We take pride in our work and are committed to building long-term relationships with our customers based on trust, transparency, and mutual respect.

RANGE OF PRODUCTS

- 1 M.S. / G.I. ERW PIPES : AS PER IS 1239, IS 3586 SQUARE & RECTANGULAR ISS 4923 / ASTM A 500 SIZE : 1/2" TO 20"**
- 2 C.S. SEAMLESS PIPES : CONFIRM TO A106 GRADE B/SA 179/DIN 17175/A333, GRADE 6/API-SL/ASTM A53. GRADE B_ CS. ERW/SEAMLESS, BOILER TUBES AS PER IS 3059 IBR & NON-IBR. SIZE : 1/2" TO 24" ASTM A 335 Gr. P12,**
- 3 STAINLESS STEEL PIPES / TUBES : (304 / 304L / 316 / 316L / 317 / 317L / 321 / 310S / 904L ERW/EFW AND SEAMLESS CONFIRMING TO A321/ A213 / A269 / A358) SIZE: Vi" TO 32"**
- 4 ALLOYS STEEL SEAMLESS PIPE P22. P9, P5 IBR & NON IBR SIZE: V2" TO 18"**
- 5 NICKEL ALLOYS PIPE, FITTINGS, FLANGES, PLATES & FASTENER : ALLOYS 20, NICKEL 200, MONEL 400 / 500, INCONEL 600 / 601/625 / 800 / 825 / 925, HASTELLOY C-276/C-22, TITANIUM, DUPLEX & SUPER DUPLEX 660A, 660B, UNS 31803, \$32750, S\$32760**
- 6 STAINLESS STEEL PLATES: Gr. OF 304, 304L, 316, 316L, 317, 317L, 321, 310L, 304L, 410, SIZE : 0.3 MM TO 100 MM THK.**
- 7 M.S. / BOILER STEEL PLATES: IS 2062 Gr. A IS 2002-62 ASTM A 516 Gr. 70/60 & HARDOX 400 / 500 SIZES: 3 MM TO 150 THK. ANGLE, CHANNEL & BEAMS**
- 8 C.S. PIPE FITTINGS & FLANGES : C.S. /FCS (A234/ A105) G.I. (ISI) (BW/SW/SCREWED) FLANGES IS 2062 / FCS 105/SORF/BLRF/SW/ WELDNECK IBR & NON IBR FLANGES TO A240 / A182 F / SORF / BLRF / SW / WELDNECK**
- 9 S.S. PIPE FITTINGS & FLANGES: S.S. 304 / 304L / 316 / 316L WELDED & SEAMLESS / BW / SW / SCREWED CONFIRMING TO A403 / A182 F & FLANGES TO A240 / A182 F / SORF / BLRF / SW / WELDNECK**
- 10 TUBE FITTINGS : SUCH AS MALE CONNECTOR, PIPE, WELD CONNECTOR, BULK HEAD MALE CONNECTOR, MALE ELBOW, MALE RUN TEE, MALE BRANCH TEE AND MANY MORE ITEMS.**
- 11 FASTENERS : STAINLESS STEEL, CARBON STEEL, NECK ALLOY, HEX BOLTS, U BOLTS, EYE BOLTS, ALLEN CAP, N1 TS, LOCKNUT, SET SCREWS, WASHERS, THREADED ROD, STONE CLADDING CLAMPS REFRACTORY ANCHORS AND MICRO NUTS, BOLT S & WASHERS.**



ASTM- AMERICAN SOCIETY FOR TESTING & MATERIALS

A 53	Welded and Seamless Steel Pipe.
A 106	Seamless Carbon Steel Pipe for High-temperature Service
A 120	Black and Hot-Dipped Zinc-Coated (Galvanized) Welded and Seamless Steel Pipe for Ordinary Uses.
A 135	Electric Resistance Welded Steel Pipe.
A 161	Seamless Low-carbon and Carbon-Molybdenum Steel Tubes for Refinery Service.
A 178	Electric Resistance Welded Carbon Steel Boiler Tubes.
A 179	Seamless Cold-drawn low-Carbon Steel Heat-Exchanger and Condenser Tubes.
A 192	Seamless Carbon Steel Boiler Tubes for high Pressure Service.
A 199	Seamless Cold-drawn Intermediate Alloy-Steel Heat Exchanger and Condenser Tubes.
A 200	Seamless Intermediate Alloy-Steel Tubes for Refinery Service.
A 209	Seamless Carbon-Molybdenum Alloy-Steel Boiler and Super-Heater Tubes.
A 210	Seamless Medium-Carbon Steel Boiler and Superheater Tubes.
A 211	Spiral Welded Steel of Iron Pipe.
A 213	Seamless Ferritic and Austenitic Alloy Steel Boiler, Superheater and Heat-Exchanger Tubes.
A 214	Electric-Resistance-Welded Carbon Steel Heat -Exchanger and Condenser Tubes.
A 226	Electric-Resistance Welded Carbon Steel Boiler and Super Heater Tubes for High-Pressure Service.
A 249	Welded Austenitic Steel Boiler, Super Heater, Heat Exchanger and Condenser Tubes.
A 250	Electric-Resistance-Welded Carbon-Molybdenum Alloy Steel Boiler and Super Heater Tubes.
A 252	Welded and Seamless Steel Pipe Piles.
A 268	Seamless and welded ferritic Steel Tubing for general Service.
A 269	Seamless and welded Austenitic Stainless Steel tubing for general service.
A 270	Seamless and welded Austenitic Stainless Steel Sanitary tubing
A 271	Seamless Austenitic Chromium-Nickel Steel Tubes for Refinery Service.
A 312	Seamless and Welded austenitic Stainless Steel Pipe.
A 333	Seamless and welded Steel Pipe for low Temperature Service.
A 334	Seamless and Welded Carbon and Alloy-Steel Tubes for Low-Temperature Service.
A 335	Seamless Ferritic Alloy Steel Pipe for High-Temperature Service.
A 376	Seamless Austenitic Steel Pipe For High-Temperature Central-Station Service.

BS- BRITISH STANDARDS

1367	Steel Tubes and Tubulars (Suitable for Screwing to BS 21 Pipe Threads)
3059	Steel Boiler and Super heater Tubes.
1139	Steel Tubes for Scaffolding.
1775	Steel Tubes for Mechanical. Structural and General Engineering Purposes.
3601	Steel Pipes and Tubes for pressure purposes, Carbon Steel Ordinary Duties.
3602	Steel Pipes and tubes for pressure Purposes carbon Steel High Duties.
3603	Steel Pipes and Tubes for Pressure Purposes Carbon and Alloy Steel Low Temperature Duties.
3604	Steel Pipes and Tubes for Pressure Purposes Low and Medium Alloy Steel.
3605	Steel Pipes and Tubes for Pressure Purposes Austenitic Medium Alloy Steel.

JIS- JAPANESE INDUSTRIAL STANDARDS

G 3452	Carbon Steel Pipes for Ordinary Piping.
G 3454	Carbon Steel Pipes for Pressure Service.
G 3455	Carbon Steel Pipe for High Pressure Service.
G 3456	Carbon Steel Pipes for High Temperature Service.
G 3457	Electric Arc Welded Carbon Steel Pipe.
G 3458	Alloy Steel Pipes.
G 3459	Austenitic Stainless Steel Pipes.
G 3460	Steel Purpose Low Temperature Service.
G 3461	Carbon Steel Boiler and Heat Exchanger Tubes.
G 3462	Alloy Steel Boiler And Heat Exchanger Tubes.
G 3463	Stainless Steel Boiler and Heat Exchanger Tubes.
G 3464	Steel Heat Exchanger Tubes for low Temperature Services.
G 3444	Carbon Steel tubes for General Structural Purposes.
G 3445	Carbon Steel Tubes for Machine Structural Purposes.
G 3441	Alloy Steel Tubes for Structure Purposes.
G 5525	Steel Pipe Piles.
G 3465	Seamless Steel Tubes for Drilling (Drill Rods)
G 3429	Seamless Steel Tubes for high pressure Gas Cylinder.
G 3442	Galvanized Steel Pipe for Water Service.
G 3443	Coating Steel Pipe for Water Service.
G 3451	Deformed Pipe for Coating Steel Pipe for Water Service.

Available Ex-stock With Test Certificate And Ibr Test Certificates In Form INA/IIB
Available Ex-stock With Certificate Astm 333 Gr. 6 & Astm 335 P-11, P5, P22

Carbon Steel Seamless Pipes
Carbon Steel Seamless Boiler
Tubes
Seamless Boiler Tubes
ERW Boiler Tubes
CDW Boiler Tubes
Alloy Steel Seamless Pipes
Alloy Steel Seamless Tubes

ASTM A 106 Grade B
BS/3059/68/Part | CDS ST-33
BS/3059/68/Part/HFS ST-33
ASTM 210 A-1/DIN 17175/
ST 35-8
BS/3059/68 Part | ERW ST-33
BS/3059/68 Part | CDW ST-33
ASTM 335 P-1, P-5, P-11, P-22
ASTM 213 T-11, T-22, ASTM 209
T-1 Din 17175 Grade 3 15 MO3

Low Temperature Seamless Pipes
Low Temperature Seamless Tubes
Heat Exchanger Tubes
API Line Pipe
MS ERW Pipes
Hot Dip Galvanised Pipes
Big Diameter
M.S. Square & Rectangular Section
M.S. General Engineering Tubes

ASTM A 333 Grade 6
ASTMA 334 Grade 1
ASTMA179
API 5 L Grade B
IS 1239 Part I-1979
IS 1239 Part II-1979
ERW Pipes 1S3589
ISS 4923 / ASTM - A500
BSS / 1775, IS 3074,
ISS 4711, ISS 3601



Pipe & Tubes

We supply Quality and durable range of seamless, ERW pipes & tubes that is used for conversance of fluids intended for critical high temperature. Seamless SS tubes are used in under similar service conditions in heat transfer process equipment like boilers, super heaters, heat exchanges and condensers.

Description	Size Rang	Specification
C.S. Seamless Pipes/Tubes	1/4" NB to 48" NB SCH 5, SCH 10 , SCH 20, SCH 40, SCH 80, SCH 160, SCH XXS	ASTM A-106 ASTMA-120 ASTM A-192
M.S. Welding Pipes/Tubes	1/2" NB to 24" NB	IS 1239 IS 3589
	SCH 5, SCH 10 , SCH 20, SCH 40, SCH 80, SCH 160, SCH XXS	



Pipe & Tube Fittings

We source and supply Quality and durable range of Pipe & Tube fittings. These pipe & tube fittings are procured from renowned vendors across the nation and matthew demands of various industries such as chemicals, fats & Fertilizers, sugar mills & distilleries, cement industries, ship builders, paper industries, pumps, petrochemicals, oil & natural gas organization (in term of the specific materials, technology, finance & personal)

Type	Butt-weldig, Forged Casting Thread Socket - Weld, Elbow, Tees, Reducer, Stub End, Unions, Cap, Nipples couplings, Elbowlets, Weldolets etc.
Item	90 Elbow (LongRadius/ Short Redius), Equal Tee, 45 Elbow (Long Redius/ Short Redius) Reducing Tee, Round Cap, Concentric Reducer, Eccentric Reducer, Stub end
C.S. Material	ASTM A106/A53/120/192/IS 1367/1139/IS 1239/IS 3589
S.S. Material	ASTM A403/WP304/WP304L/WP316/WP316TI/321/310/347/904L
Dimension	ANSI B16.9/ MSS SP-43/ JIS B2313
Thickness	SCH5S / SCH10S / SCH40S / SCH80S / SCH120S SCH160S / SCHXXS
Size	1/2" - 48"
Method	Seamless and ERW
Make	Manufactures & As per design & Specification





SPECIFICATIONS FOR MILD STEEL TUBES & TUBULARS

CONFORMING TO IS-1239 (PART I) : 1990

Nominal Bore(NB)		Class	Outside Diameter MAX MIN		Thickness	SWG	Mass of Black Tube P/E S/S		Black Plain End			Calculated Wt. of Galvanised Tube P/E S/S		Galvanised S & S		
mm	inches		mm	mm			mm	kg/mm	kg/mm	Mtrs/Ton	Ft/Ton	Pcs/Blde	kg/m	kg/m	Mtrs/Ton	Ft/Ton
15	(½")	L	21.40	21.00	2.00	14	0.947	0.956	1056	3465	176	0.999	1.008	992	3255	165
		M	21.80	21.00	2.60	12	1.21	1.22	826	2710	138	1.264	1.274	785	2575	131
		H	21.80	21.00	3.20	10	1.44	1.45	694	2277	116	1.494	1.504	665	2182	111
20	(¾")	L	26.90	26.40	2.30	13	1.38	1.39	725	2379	121	1.441	1.451	689	2260	115
		M	27.30	26.50	2.60	12	1.56	1.57	641	2103	107	1.622	1.632	613	2011	102
		H	27.30	26.50	3.20	10	1.87	1.88	535	1755	89	1.923	1.933	517	1696	86
25	(1")	L	33.80	33.20	2.60	12	1.98	2.00	505	1657	84	2.062	2.082	480	1575	80
		M	34.20	33.30	3.20	10	2.41	2.43	415	1362	69	2.495	2.515	398	1306	66
		H	34.20	33.30	4.00	8	2.93	2.95	341	1119	57	3.028	3.048	328	1076	55
32	(1¼")	L	42.50	41.90	2.60	12	2.54	2.57	394	1293	66	2.641	2.671	374	1227	62
		M	42.90	42.00	3.20	10	3.10	3.13	323	1060	54	3.207	3.237	309	1014	52
		H	42.90	42.00	4.00	8	3.79	3.82	264	866	44	3.887	3.917	255	837	43
40	(1½")	L	48.40	47.80	2.90	11	3.93	3.27	310	1017	52	3.358	3.398	294	965	46
		M	48.80	47.90	3.20	10	3.53	3.60	281	922	47	3.681	3.721	269	883	45
		H	48.80	47.90	4.00	8	4.37	4.41	229	751	38	4.485	4.525	221	725	37
50	(2")	L	60.20	59.60	2.90	11	4.08	4.15	245	805	41	4.225	4.295	233	764	39
		M	60.80	59.70	3.60	9	5.03	5.10	199	653	33	5.166	5.236	191	627	32
		H	60.80	59.70	4.50	7	6.19	6.26	162	531	27	6.349	6.419	156	512	26
65	(2½")	L	76.00	75.20	3.20	10	5.71	5.83	175	574	29	5.898	6.018	166	545	28
		M	76.60	75.30	3.60	9	6.42	6.54	156	512	26	6.621	6.741	144	486	25
		H	76.60	75.30	4.50	7	7.93	8.05	126	413	21	8.095	8.215	122	400	20
80	(3")	L	88.70	87.90	3.20	10	6.72	6.89	149	489	25	6.925	7.122	140	459	23
		M	89.50	88.00	4.00	8	8.36	8.53	120	394	20	8.586	8.756	114	374	19
		H	89.50	88.00	4.80	6	9.9	10.40	101	331	17	10.109	10.609	97	318	16
100	(4")	L	113.90	113.00	3.60	9	9.75	10.10	103	338	17	10.276	10.586	94	308	16
		M	115.00	113.10	4.50	7	12.20	12.50	82	269	14	12.758	13.258	75	246	13
		H	115.00	113.10	5.40	5	14.50	14.80	69	226	12	15.252	15.552	64	210	11
125	(5")	M	140.80	138.50	4.80	6	15.90	16.40	63	207	11	16.649	17.149	58	190	10
		H	140.80	138.50	5.40	5	17.90	18.40	56	184	9	18.619	19.119	52	171	9
150	(6")	M	166.50	163.90	4.80	6	18.90	19.50	53	174	9	19.700	20.300	49	161	8
		H	166.50	163.90	5.40	5	21.30	21.90	47	154	8	22.322	22.922	44	144	7

TOLERANCE : Thickness : Light : + Unlimited Medium / Heavy : + Unlimited
- 8 % - 10 %

Weight : Light ± 5% Medium/Heavy : ± 7.5%
(For Quantities per load of 10 Tonnes Minimum)

HYDRO TEST PRESSURE : 5 MPa

IS : 1239 (Part I) - 1979 Mild Steel Tubes
Maximum Permissible Pressure and temperature
for tubes for conveying steam

The maximum permissible Pressure and temperature for tubes with screwed and socketed joint shall be as follows.

MAXIMUM PERMISSIBLE PRESSURE AND TEMPERATURE FOR TUBES WITH STEEL COUPLING OR SCREWED AND SOCKETED JOINTS

Nominal Bore	Maximum Permissible Pressure		Maximum Permissible Temperature
	N/mm ²	Kg/Cm ²	
mm			°C
Up to and including 25 mm	1.20	12.24	260
Over 25 mm upto and including 40 mm	1.03	10.50	260
Over 40 mm upto and including 80 mm	0.86	8.77	260
Over 80 mm upto and including 100 mm	0.69	7.04	260
	0.83	8.47	177
Over 100 mm upto and including 125 mm	0.69	7.04	171
Over 125 mm upto and including 150 mm	0.50	5.10	160



DIMENSIONS ANS B 36-10

Size of Pipes & Tubes			Nominal Thickness and weight													
			Number of Schedule													
			5S		10S		10		20		30		40		60	
Nominal Inch.	DN	Outside in Inch.	mm	kg/m	mm	kg/m	mm	kg/m	mm	kg/m	mm	kg/m	mm	kg/m	mm	kg/m
1/8"	6	10.3	-	-	1.28	0.28	-	-	1.60	0.345	-	-	1.73	0.37	-	-
1/4"	8	13.7	-	-	1.65	0.49	-	-	2.00	0.580	-	-	2.24	0.63	-	-
3/8"	10	17.1	-	-	1.65	0.63	-	-	2.00	0.750	-	-	2.31	0.84	-	-
1/2"	15	21.3	1.65	0.81	2.11	1.00	-	-	2.00	0.957	-	-	2.77	1.27	-	-
3/4"	20	26.7	1.65	1.03	2.11	1.28	-	-	2.50	1.500	-	-	2.87	1.69	-	-
1"	25	33.4	1.65	1.29	2.77	2.08	-	-	3.00	2.240	-	-	3.38	2.50	-	-
1 1/4"	32	42.2	1.65	1.65	2.77	2.69	-	-	3.00	2.910	-	-	3.56	3.39	-	-
1 1/2"	40	48.3	1.65	1.90	2.77	3.12	-	-	3.00	3.370	-	-	3.68	4.05	-	-
2"	50	60.3	1.65	2.38	2.77	3.94	-	-	3.00	4.263	-	-	3.91	5.44	-	-
2 1/2"	65	73.0	2.11	3.70	3.05	5.26	-	-	4.00	6.486	-	-	5.16	8.63	-	-
3"	80	88.9	2.11	4.50	3.05	6.45	-	-	4.00	8.423	-	-	5.49	11.29	-	-
3 1/2"	90	101.6	2.11	5.20	3.05	7.40	-	-	4.50	10.838	-	-	5.74	13.57	-	-
4"	100	114.3	2.11	5.81	3.05	8.34	-	-	4.50	12.555	-	-	6.02	16.07	-	-
5"	125	141.3	2.77	9.45	3.40	11.56	-	-	5.00	16.900	-	-	6.55	21.77	-	-
6"	150	168.3	2.77	11.31	3.40	13.82	-	-	6.35	24.150	-	-	7.11	28.26	-	-
8"	200	219.1	2.77	14.78	3.76	19.94	-	-	6.35	33.31	7.04	36.81	8.18	42.55	10.31	53.08
10"	250	273.0	3.40	22.62	4.19	27.83	-	-	6.35	41.75	7.80	51.01	9.27	60.29	12.70	81.52
12"	300	323.9	3.96	33.00	4.57	36.00	-	-	6.35	49.71	8.38	65.18	10.31	79.70	14.27	108.92
14"	350	355.6	3.96	34.23	4.78	41.18	6.35	54.69	7.92	67.90	9.53	81.25	11.13	94.55	15.09	126.71
16"	400	406.4	4.19	41.60	4.78	47.38	6.35	62.64	7.92	77.83	9.53	93.17	12.70	123.30	16.66	160.12
18"	450	457.2	4.19	46.83	4.78	53.18	6.35	70.60	7.92	87.75	11.13	122.43	14.27	155.87	19.05	205.83
20"	500	508.0	4.78	59.22	5.54	68.50	6.35	78.55	9.53	117.02	12.70	155.12	15.09	183.42	20.62	247.83
22"	550	558.8	4.78	63.75	5.54	73.81	6.35	86.50	9.53	129.01	12.70	171.01	-	-	22.23	294.25
24"	600	609.6	5.54	82.60	6.35	94.37	6.35	94.46	9.53	140.88	14.27	209.50	17.48	254.24	24.61	355.02
26"	650	660.4	-	-	-	-	7.92	127.43	12.70	202.85	-	-	-	-	-	-
28"	700	711.2	-	-	-	-	7.92	137.42	12.70	218.73	15.88	272.18	-	-	-	-
30"	750	762.0	-	-	-	-	7.92	147.36	12.70	234.64	15.88	292.06	-	-	-	-
32"	800	812.8	-	-	-	-	7.92	157.28	12.70	250.55	15.88	311.95	17.48	342.70	-	-
34"	850	863.6	-	-	-	-	7.92	167.20	12.70	266.46	15.88	331.83	17.48	364.58	-	-
36"	900	914.4	-	-	-	-	7.92	177.13	12.70	282.36	15.88	351.72	19.05	420.56	-	-

N.B. : thickness and weight "Standard" "Extra Strong" & "Double Extra Strong" within swell edges have a correspondent Value in "schedule" for different thickness that suitable the weight can proceed by following formula $24.66 (d/t/t)$



DIMENSIONS ANS B 36-10

Nominal Thickness and weight															
		Number of Schedule													
80		100		120		140		160		Standard (STD)		Extra Strong		Double Ex. Strong	
Nominal in Inch.	Outside in Inch.	mm	kg/m	mm	kg/m	mm	kg/m	mm	kg/m	mm	kg/m	mm	kg/m	mm	kg/m
2.41	0.47	-	-	-	-	-	-	-	-	1.73	0.37	2.41	0.47	-	-
3.02	0.80	-	-	-	-	-	-	-	-	2.24	0.63	3.02	0.80	-	-
3.20	1.10	-	-	-	-	-	-	-	-	2.31	0.84	3.20	1.10	-	-
3.73	1.62	-	-	-	-	-	-	4.78	1.95	2.77	1.27	3.73	1.62	7.47	2.55
3.91	2.20	-	-	-	-	-	-	5.56	2.90	2.87	1.69	3.91	2.20	7.82	3.64
4.55	3.24	-	-	-	-	-	-	6.35	4.24	3.38	2.50	4.55	3.24	9.09	5.45
4.85	4.47	-	-	-	-	-	-	6.35	5.61	3.56	3.39	4.85	4.47	9.70	7.77
5.08	5.41	-	-	-	-	-	-	7.14	7.25	3.68	4.05	5.08	5.41	10.15	9.56
5.54	7.48	-	-	-	-	-	-	8.74	11.11	3.91	5.44	5.54	7.48	11.07	13.44
7.01	11.41	-	-	-	-	-	-	9.53	14.90	5.16	8.63	7.01	11.41	14.02	20.39
7.62	15.27	-	-	-	-	-	-	11.13	21.30	5.49	11.29	7.62	15.27	15.24	27.68
8.08	18.63	-	-	-	-	-	-	-	-	5.74	13.57	8.08	18.63	-	-
8.56	22.32	-	-	11.13	28.25	-	-	13.49	33.54	6.02	16.07	8.56	22.32	17.12	41.03
9.53	30.94	-	-	12.70	40.28	-	-	15.88	49.11	6.55	21.77	9.53	30.94	19.05	57.43
10.97	42.56	-	-	14.27	54.20	-	-	18.26	67.56	7.11	28.26	10.97	42.56	21.95	79.22
12.70	64.64	15.09	75.92	18.26	90.44	20.62	100.92	23.01	111.27	8.18	42.55	12.70	64.64	22.22	107.88
15.09	95.97	18.26	114.70	21.44	133.00	25.40	155.09	28.58	172.33	9.27	60.29	12.70	81.52	25.40	155.09
17.48	132.04	21.44	159.86	25.40	186.91	28.58	208.00	33.32	238.68	9.53	73.78	12.70	97.43	25.40	186.91
19.05	158.10	23.83	194.96	27.79	224.65	31.75	253.56	35.71	281.70	9.53	81.25	12.70	107.39	-	-
21.44	203.53	26.19	245.56	30.96	286.64	36.53	333.19	40.49	364.35	9.53	93.17	12.70	123.30	-	-
23.83	254.67	29.36	309.76	34.92	363.64	39.67	408.45	45.24	459.59	9.53	105.10	12.70	139.20	-	-
26.19	311.17	32.54	381.53	38.10	441.49	44.45	508.11	50.01	564.81	9.53	117.02	12.70	155.10	-	-
28.58	373.83	34.93	451.52	41.28	527.02	47.63	600.63	53.98	672.26	9.53	129.01	12.70	171.01	-	-
30.96	441.78	38.89	547.73	46.02	639.58	52.37	719.63	59.54	807.63	9.53	140.88	12.70	186.94	-	-
-	-	-	-	-	-	-	-	-	-	9.53	152.80	12.70	202.85	-	-
-	-	-	-	-	-	-	-	-	-	9.53	164.80	12.70	218.73	-	-
-	-	-	-	-	-	-	-	-	-	9.53	176.73	12.70	234.64	-	-
-	-	-	-	-	-	-	-	-	-	9.53	188.66	12.70	250.55	-	-
-	-	-	-	-	-	-	-	-	-	9.53	200.59	12.70	266.46	-	-
-	-	-	-	-	-	-	-	-	-	9.53	212.52	12.70	282.36	-	-

N.B. : thickness and weight "Standard" "Extra Strong" & "Double Extra Strong" within swell edges have a correspondent Value in "schedule" for different thickness that suitable the weight can proceed by following formula $24.66 (d/t/t)$



BUTT-WELD FITTINGS

The following table represents size range, product standards and material grades of industrial pipe fittings like stainless steel, carbon steel & alloy steel pipe fittings etc. The range includes.

MATERIAL TYPE:-

Stainless Steel :	ASTM A403 WP304, 304L, 304H, 316, 316L, 316Ti, 317, 317L, 321, 309, 310, 310S, 347, 347H, 904L etc.
Carbon Steel :	ASTM A-234 WPB/A420 WPL 3/A420 WPL6/MSS-SP-75 WPHY 42/46/52/56/60/65/70 etc. (IBR & NON IBR)
Alloy Steel :	ASTM A234, GR.WP1, WP5, W9, WP11, WP12, WP22, WP91 etc.
Others :	Monel, Nickel, Inconel, Hastalloy, Copper, Brass, Bronze, Titanium, Bismuth, Aluminium, High Speed Steel, Zinc, Lead etc.
Type :	Elbow, Tee, Reducer, Return Bends, Stub-Ends, Cap, Collar, Nipple, Cross, Insert etc.
Size Range :	1/8" NB to 48" NB [Seamless & ERW (Welded)]
Wall Thickness :	Sch. 5S to Sch. XXS

Used to allow flow of Fluids, like steam, water, air, oil, etc, throught the desired cross-section with diversion of flow to the desired point



FLANGES

FORGED FITTINGS SOCKET WELD

The following table represents size range, product standards and material grades of industrial steel flanges, stainless steel, carbon steel & alloy steel flanges etc. The range includes:

MATERIAL TYPE:-

Stainless Steel :	ASTM A-240/A182 F 304, 304L, 304H, 316, 316L, 316Ti, 309, 309H, 310, 310S, 317, 317L, 321, 347, 904L
Carbon Steel :	ASTM A105/IS- 2062, A350 LF3/A350 Lf2, Lf3 etc. (IBR & NON IBR)
Alloy Steel :	ASTM A182 F1/F5/F9/F11/F22/F9 1 etc.
Others :	Monel, Nickel, Inconel, Hastalloy, Copper, Brass, Bronze, Titanium, Tantalum, Bismuth, Aluminium, High Speed Steel, Zinc, Lead etc.
Type :	Slipon, Blind, Weld Neck, Socket Weld, Screwed, Lap Joint, Ring Joint, Spectacle, Orifcae, Reducing, Plate, Plate Blank etc.
Size Range :	1/2" NB to 48" NB
Wall Thickness :	150#, 300#, 6004, 900#, 1500#, 2500#, BS-10 Standard Table D, E, F, H & ALSO DIN Standard

- Used to connect ends of pipes, inlets & outlets of equipments allowing flow from one point to the desired points with necessary diversion of flow of fluids like air, steam, water, oil etc.
- To allow equipment, instruments, etc, to be installe dinto the flowing media for proper control of the flow,
- To allow provision for easy maintenance of the processing systems under any working condition.



S.S. BUTT WELDED PIPE FITTINGS DIMENSION STANDARD ANSI -B-16.9 ANB-16.28



Nom.	Pipe	Wall Thickness				Radius				A	B	C	E	G	Length		H	D	h
		5S	10S	40S	80S	1D	1.5D	2D	3D						L	L			
Bore inch	O.D.																		
1/2	21.34	1.65	2.11	2.77	3.73	12.7	19.06	25.4	38.1	12.7	15.9	25.4	25.4	34.9	50.8	76.2	508.	42	8
3/4	26.67	1.65	2.11	2.87	3.91	19.05	28.57	38.10	57.15	19.05	11.1	28.6	25.4	42.8	50.8	76.2	50.8	52	8
1	33.40	1.65	2.77	3.38	4.55	25.4	38.1	50.8	76.2	52.4	22.2	38.1	38.1	50.8	50.8	101.6	50.8	65	10
1¼	42.16	1.65	2.77	3.56	4.85	31.75	47.6	63.5	95.25	31.75	25.0	47.6	38.1	63.1	50.8	101.6	50.8	72	12
1½	48.26	1.65	2.77	3.68	5.08	38.1	57.15	76.2	114.3	38.10	28.6	57.2	38.	73.0	50.8	101.6	63.5	82	12
2	60.32	1.65	2.77	3.91	5.54	50.8	76.2	101.6	152.4	50.8	34.0	63.5	38.1	92.0	63.5	152.4	76.2	98	16
2½	73.02	2.11	3.05	5.16	7.01	63.5	95.25	127.0	190.5	63.5	44.0	76.2	38.1	104.8	63.5	152.4	88.9	118	15
3	88.90	2.11	3.05	5.49	7.62	76.2	114.30	152.4	228.6	76.2	50.8	85.7	50.8	127.0	63.5	152.4	88.9	130	18
3½	101.60	2.11	3.05	5.74	8.08	88.9	33.35	177.8	266.7	88.9	57.2	99.3	63.5	139.7	76.2	152.4	101.6	140	18
4	114.30	2.11	3.05	6.02	8.56	101.6	152.4	203.2	304.8	101.6	63.5	104.8	63.5	157.2	76.2	152.4	101.6	168	20
5	141.30	2.77	3.40	6.55	9.52	127.0	190.5	254.0	381.0	127.0	82.6	123.8	76.2	185.7	76.2	203.2	127.0	188	25
6	168.27	2.77	3.40	7.11	10.97	152.4	228.6	304.8	457.2	152.4	95.3	142.7	88.9	215.9	88.9	203.2	139.7	215	25
8	219.07	2.77	3.76	8.18	12.7	203.2	304.8	406.4	609.6	203.2	127.0	177.5	101.6	270.0	101.6	203.2	152.4	270	30
10	273.05	3.40	4.19	9.27	12.7	254.0	381.0	508.0	762.0	254.0	158.7	275.9	127.0	324.0	127.0	254.0	177.8	330	35
12	323.85	3.96	4.57	9.52	12.7	304.8	457.2	609.6	914.4	340.8	190.5	254.0	152.4	381.0	152.4	254.0	203.2	400	40
14	355.60	3.96	4.76	9.52	12.7	355.6	533.4	711.2	1066	355.6	222.2	280.0	165.1	412.8	152.4	305.0	330.2	470	40
16	406.40	4.19	4.76	9.52	12.7	406.4	609.6	812.8	1219	406.4	254.0	340.8	177.8	470.0	152.4	305.0	355.6	535	40
18	457.20	4.19	4.76	9.52	12.7	457.2	685.8	914.4	1372	457.2	285.7	343.0	203.2	533.4	152.4	305.0	381.0	535	40
20	508.00	4.76	5.54	9.52	12.7	508.0	762.0	1015	1524	508.0	317.6	381.0	228.6	584.2	152.4	305.0	508.0	642	40
24	609.60	5.54	6.35	9.52	12.7	609.6	914.4	1219	1829	-	881.0	431.8	266.7	698.5	152.4	305.0	508.0	693	40



DIMENSION OF FLANGES ANSI B16.5 - 1988

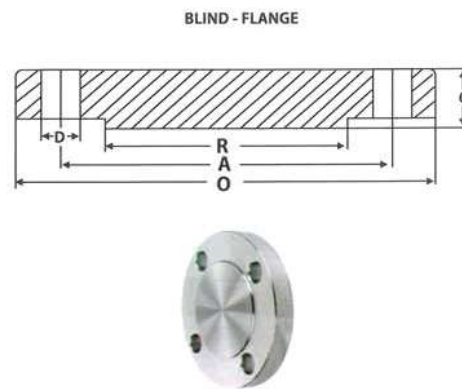
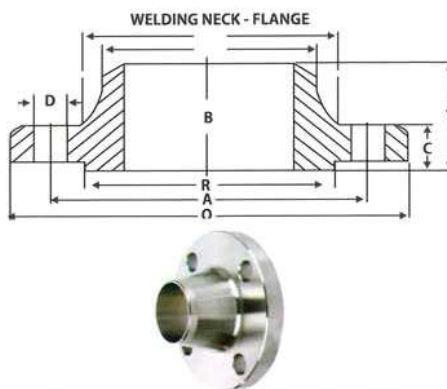
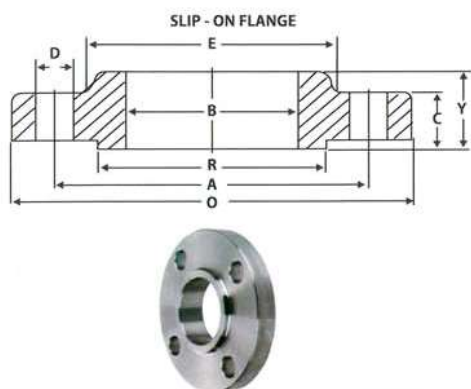

DIMENSION OF CLASS 150 FLANGES PER ANSI B 16.5

Nominal Pipe Size	Flange Dia O	Dia of Bolt Circle A	Dia of Bolt Holes D	No. of Holes	Thickness of Flange C	Dia of Hub E	Length through Hub			Dia of Bore		Dia of R/F R	Depth of Socket F
							S/O & S/W Y	W/N Y	L/J Y	S/O & S/W B	L/J B		
15	88.9	60.3	15.9	4	11.1	30.2	15.9	47.6	15.9	22.3	22.9	34.9	9.5
20	98.4	69.8	15.9	4	12.7	38.1	15.9	52.4	15.9	27.7	28.2	42.9	11.1
25	107.9	79.4	15.9	4	14.3	49.2	17.5	55.6	17.5	34.5	35.0	50.8	12.7
32	117.5	88.9	15.9	4	15.9	58.7	20.6	57.1	20.6	43.2	43.7	63.5	14.3
40	127.0	98.4	15.9	4	17.5	65.1	22.2	61.9	22.2	49.5	50.0	73.0	15.9
50	152.4	120.6	19.0	4	19.0	77.8	25.4	63.5	25.4	62.0	52.5	92.1	17.5
65	177.8	139.7	19.0	4	22.2	90.5	28.6	69.8	28.6	74.7	75.4	104.8	19.0
80	190.5	152.4	19.0	4	23.8	107.9	30.2	69.8	30.2	90.7	91.4	127.0	20.6
100	228.6	190.5	19.0	8	23.8	134.9	33.3	76.2	33.3	116.1	116.8	157.2	23.8
125	254.0	215.9	22.2	8	23.8	163.5	36.5	88.9	36.5	143.8	144.5	185.7	23.8
150	279.4	241.3	22.2	8	25.4	192.1	39.7	88.9	39.7	170.7	171.4	215.9	27.0
200	342.9	293.4	22.2	8	28.6	246.1	44.4	101.6	44.4	221.5	222.2	269.9	31.7
250	406.4	361.9	25.4	12	30.2	304.8	49.2	101.6	49.2	276.3	277.4	323.8	33.3
300	482.6	431.8	25.4	12	31.8	365.4	55.6	114.3	55.6	327.1	328.2	381.0	39.7
350	533.4	476.2	28.6	12	34.9	100.0	57.1	127.0	79.4	359.1	360.2	412.7	41.3
400	596.9	539.7	28.6	16	36.5	457.2	63.5	127.0	87.3	410.5	411.2	469.9	44.4
450	635.0	577.8	31.6	16	39.7	504.8	68.3	139.7	96.8	461.8	462.3	533.4	49.2
500	698.5	635.0	31.6	20	42.9	558.8	73.0	144.5	103.2	513.1	514.3	584.2	54.0
600	812.8	749.3	34.9	20	47.6	663.6	82.5	152.4	111.1	615.9	615.9	692.1	63.5

DIMENSION OF CLASS 300 FLANGES PER ANSI B 16.5

Nominal Pipe Size	Flange Dia O	Dia of Bolt Circle A	Dia of Bolt Holes D	No. of Holes	Thickness of Flange C	Dia of Hub E	Length through Hub			Dia of Bore		Dia of R/F R	Depth of Socket F
							S/O & S/W Y	W/N Y	L/J Y	S/O & S/W B	L/J B		
15	95.2	66.7	15.9	4	14.3	38.1	22.2	52.4	22.2	22.3	22.9	34.9	9.5
20	117.5	82.5	19.0	4	15.9	47.6	25.4	57.1	25.4	27.7	28.2	42.9	11.1
25	123.8	88.9	19.0	4	17.5	54.0	27.0	61.9	27.0	34.5	35.0	50.8	12.7
32	133.3	98.4	19.0	4	19.0	63.5	27.0	65.1	27.0	43.2	43.7	63.5	14.3
40	155.6	114.3	22.2	4	20.6	69.8	30.2	68.3	30.2	49.5	50.0	73.0	15.9
50	165.1	127.0	19.0	8	22.2	84.1	33.3	69.8	33.3	62.0	52.5	92.1	17.5
65	190.5	149.2	22.2	8	25.4	10.0	38.1	76.2	38.1	74.7	75.4	104.8	19.0
80	209.5	168.3	22.2	8	28.6	117.5	42.9	79.4	42.9	90.7	91.4	127.0	20.6
100	254.0	200.0	22.2	8	31.8	146.0	47.6	85.7	47.6	116.1	116.8	157.2	23.8
125	279.4	234.9	22.2	8	34.9	177.8	50.8	98.4	50.8	143.8	144.5	185.7	-
150	317.5	269.9	22.2	12	36.5	206.4	52.4	98.4	52.4	170.7	171.4	215.9	-
200	381.0	330.2	25.4	12	41.3	260.3	61.9	111.1	61.9	211.5	222.2	269.9	-
250	444.5	387.3	28.6	16	47.6	320.7	66.7	117.5	95.2	276.3	277.4	323.8	-
300	520.7	450.8	31.7	16	50.8	374.6	73.0	130.2	101.6	327.1	328.2	381.0	-
350	584.2	514.3	31.7	20	54.0	425.4	76.2	142.9	111.1	359.1	360.2	412.7	-
400	647.7	571.5	34.9	20	57.2	482.6	82.5	146.0	120.6	410.5	411.2	469.9	-
450	711.2	628.5	34.9	24	60.3	533.4	88.9	158.7	130.2	461.8	462.3	533.4	-
500	774.7	685.8	34.9	24	63.5	587.4	95.2	161.9	139.7	513.1	514.3	584.2	-
600	914.4	812.8	41.3	24	69.8	701.7	106.4	168.3	152.4	615.9	615.9	692.1	-



DIMENSION OF FLANGES AS PER TABLE BS - 10

TABLE D

FOR WORKING STEAM PRESSURE UPTO 50 LBS PER SQ. INCH

Nominal Pipe Size	O.D. of Pipe	O.D.	P.C. D.	No. of Bolt	Dia of Bolt	Thickness
1 / 2"	21.3	95.3	66.7	4	12.7	4.8
3 / 4"	26.7	101.3	73.0	4	12.7	4.8
1"	33.4	114.3	82.6	4	12.7	4.8
1-1/4"	42.2	120.7	87.3	4	12.7	6.4
1-1/2"	48.3	133.4	98.4	4	12.7	6.4
2"	60.3	152.4	114.3	4	15.9	7.9
2-1/2"	73.0	165.1	127.0	4	15.9	7.9
3"	88.9	184.2	145.1	4	15.9	9.5
3-1/2"	101.6	203.2	165.1	4	15.9	9.5
4"	114.3	215.9	177.8	4	15.9	9.5
5"	141.3	254.0	209.6	8	15.9	12.7
6"	168.3	279.4	235.6	8	15.9	12.7
7"	190.5	304.8	260.4	8	15.9	12.7
8"	219.1	336.6	292.1	8	15.9	12.7
9"	244.5	368.3	323.9	8	15.9	15.9
10"	273.0	406.4	355.6	8	19.1	15.9
12"	323.9	457.2	406.4	12	19.1	15.9
14"	355.6	527.1	469.6	12	22.2	19.1
16"	406.4	577.9	520.7	12	22.2	19.1
18"	457.2	641.4	584.2	12	22.2	22.2
20"	508.0	704.9	641.4	16	22.5	25.4
24"	609.6	825.5	755.7	16	25.4	28.6

TABLE E

FOR WORKING STEAM PRESSURE UPTO 100 LBS PER SQ. INCH

Nominal Pipe Size	O.D. of Pipe	O.D.	P.C. D.	No. of Bolt	Dia of Bolt	Thickness
1 / 2"	21.3	95.3	66.7	4	12.7	6.4
3 / 4"	26.7	101.3	73.0	4	12.7	6.4
1"	33.4	114.3	82.6	4	12.7	7.1
1-1/4"	42.2	120.7	87.3	4	12.7	7.9
1-1/2"	48.3	133.4	98.4	4	12.7	8.7
2"	60.3	152.4	114.3	4	15.9	9.5
2-1/2"	73.0	165.1	127.0	4	15.9	10.3
3"	88.9	184.2	145.0	4	15.9	11.1
3-1/2"	101.6	203.2	165.1	8	15.9	11.9
4"	114.3	215.9	177.8	8	15.9	12.7
5"	141.3	254.0	209.6	8	15.9	14.3
6"	168.3	279.4	235.6	8	19.1	17.5
7"	190.5	304.8	260.4	8	19.1	19.1
8"	219.1	336.6	292.1	8	19.1	19.1
9"	244.5	368.3	323.9	12	19.1	20.6
10"	273.0	406.4	355.6	12	19.1	22.2
12"	323.9	457.2	406.4	12	22.2	25.4
14"	355.6	527.1	469.6	12	22.2	25.4
16"	406.4	577.9	520.7	12	22.2	25.4
18"	457.2	641.4	584.2	16	22.2	28.6
20"	508.0	704.9	641.0	16	22.2	31.8
24"	609.6	825.5	755.7	16	25.4	38.1

TABLE F FOR WORKING STEAM PRESSURE
ABOVE 100 LBS AND UPTO 150 LBS PER SQ. INCH

Nominal Pipe Size	O.D. of Pipe	O.D.	P.C. D.	No. of Bolt	Dia of Bolt	Thickness
1 / 2"	21.3	95.3	66.7	4	12.7	9.5
3 / 4"	26.7	101.3	73.0	4	12.7	9.5
1"	33.4	120.7	87.3	4	15.9	9.5
1-1/4"	42.2	133.4	98.4	4	15.9	12.7
1-1/2"	48.3	139.7	104.8	4	15.9	12.7
2"	60.3	165.1	127.0	4	15.9	15.9
2-1/2"	73.0	184.2	145.0	8	15.9	15.9
3"	88.9	203.2	165.1	8	15.9	15.9
3-1/2"	101.6	215.9	177.8	8	15.9	19.1
4"	114.3	228.6	190.5	8	15.9	19.1
5"	141.3	279.4	235.0	8	19.1	22.2
6"	168.3	304.8	260.4	12	19.1	22.2
7"	190.5	336.6	292.1	12	19.1	22.2
8"	219.1	368.3	323.9	12	19.1	25.0
9"	244.5	406.4	355.6	12	22.2	25.0
10"	273.0	431.8	381.0	12	22.2	25.0
12"	323.9	489.0	438.2	16	22.2	28.6
14"	355.6	552.5	495.3	16	25.4	31.8
16"	406.4	609.6	552.5	20	25.4	31.8
18"	457.2	673.1	609.6	20	28.6	34.9
20"	508.0	736.6	673.1	24	28.6	38.1
24"	609.6	850.9	781.1	24	31.8	41.3

TABLE H For working Steam pressure
ABOVE 150 LBS AND UPTO 250 LBS PER SQ. INCH

Nominal Pipe Size	O.D. of Pipe	O.D.	P.C. D.	No. of Bolt	Dia of Bolt	Thickness
1 / 2"	21.3	114.3	82.6	4	15.9	12.7
3 / 4"	26.7	114.3	82.6	4	15.9	12.7
1"	33.4	120.7	87.3	4	15.9	14.3
1-1/4"	42.2	133.4	98.4	4	15.9	17.0
1-1/2"	48.3	139.7	104.8	4	15.9	17.0
2"	60.3	165.1	127.0	4	15.9	19.1
2-1/2"	73.0	184.2	145.0	8	15.9	19.1
3"	88.9	203.0	165.1	8	15.9	22.2
3-1/2"	101.6	215.9	177.8	8	15.9	22.2
4"	114.3	228.6	190.5	8	15.9	25.4
5"	141.3	279.4	235.0	8	19.1	28.6
6"	168.3	304.8	260.4	12	19.1	28.6
7"	190.5	336.6	292.1	12	19.1	31.8
8"	219.1	368.3	323.9	12	19.1	31.8
9"	244.5	406.4	355.6	12	22.2	34.9
10"	273.0	431.8	381.0	12	22.2	34.9
12"	323.9	489.0	438.2	16	22.2	38.1
14"	355.6	552.5	495.3	16	25.4	41.3
16"	406.4	609.6	552.5	20	25.4	44.5
18"	457.2	673.1	609.6	20	28.6	47.6
20"	508.0	736.6	673.1	24	28.6	50.8
24"	609.6	850.9	781.1	24	31.8	57.2

NOTE : FOR 12.7 MM AND 15.87 BOLTS DIA THE DIAMETERS OF THE HOLES WILL BE 1.58MM LARGER AND FOR 19.01 AND ABOVE
THE HOLE DIA WILL BE 3.18 LARGER



EQUAL TEE



CROSS



STREET ELBOW



M/F UNION



COPLING



HEX HEAD PLUG



FLUSH BUSHING



SQ HEAD PLUG



HEX BUSHING



CAP



UNION



BARREL



HEX NIPPLES

FORGED FITTINGS SCREWED

The following table represents size range, product standards and material grades of forged high pressure fittings, screwed, like stainless steel, carbon steel & alloy steel etc. The range includes:

MATERIAL TYPE:-

Stainless Steel :	ASTM A182 F304/304L] 304H/ 316/ 316L/ 317/ 317L/ 321/ 310/ 347/ 904L etc.
Carbon Steel :	ASTM A105/ A105N/ A694 F42/46/52/56/60/65/70/ A350LF3/ A350 LF2 etc.
Alloy Steel :	ASTM A182 F1/F5/F9/F11/F22/F9 etc.
Others :	Monel, Nickel, Inconel, Hastalloy, Copper, Brass, Bronze, Titanium, Tantalum, Bismuth, Aluminium, High Speed Steel, Zinc, Lead etc.
Type :	Elbow, Tee, Union, Cross, Coupling, Cap, Bushing, Plug, Swage nipple, Welding Boss, Hexagon Nipple, Barrel Nipple, Welding Nipple, Parraler Nipple, Street Elbow, Hexagon Nut, Hose Nipple, Bend, Adapter, Insert, Cross, Weldolet, Elbowlet, Sockolet, Thredolet, Nipolet Letrolet etc.
Size Range:	1/8" NB to 4" NB (Threaded)
Wall Thickness:	150#, 30004, 6000# & 9000#.

Used to allow of fluids through desired sizes of flowing cross - section with diversion of flow to the desired points under normal condition.

NOTE: FOR 12.7 MM AND 15.87 BOLTS DIA THE DIAMETERS F THE HOLES WILL BE 1.58MM LARGER AND FOR 19.01 AND ABOVE THE HOLE DIA WILL BE 3.17 LARGER.



BUTTERFLY VALVE



AP | 609 / BS 5155 / 1S 13095 / CAST IRON

OPERATING : LEVER / MANUAL GEAR

DESIGN: SURE SEAL / REPLACEABLE RUBBER LINING

ENDS : WAFER TYPE / DOUBLE FLANGE

SIZE : LEVER / GEAR (ISI MARKED)

350 MM TO 1200 MM

CAST CARBON STEEL

DESIGN : SURE SEAL/ REPLACEABLE

ENDS : RUBBER LINING

SIZE : WAFER TYPE

40 MM TO 500 MM

STAINLESS STEEL

DESIGN : OFFSET DISC.

OPERATION : LEVER / MANUAL / GEAR

ENDS : WAFER TYPE

SIZE : 40 MM TO 400 MM

Mfg. STD : BS 5155 / AWWA C 504 API 609 /

IS 13095

TEST STD : BS 6155/ BS 6755

STRAINER



CAST CARBON STEEL/ S. STEEL

DESIGN : Y-TYPE (PN 40/ DIN 3356/ BS 1873)

SIZE : 15 MM TO 300 MM

STAINLESS STEEL

DESIGN : Y-TYPE (150#)

ENDS : SCREWED/ SOCKET WELD

SIZE : 15MM TO 80MM

CAST IRON

DESIGN : Y-TYPE (150#)

ENDS : SCREWED/ FLANGED

SIZE : 15MM TO 300 MM

DESIGN : POT TYPE

ENDS : FLANGED

SIZE : 40 MM TO 300 MM

DESIGN : T-TYPE (DIRT BOX)

ENDS : FLANGED

SIZE : 25 MM TO 300 MM

DIN NON RETURN VALVE



CAST CARBON STEEL S. STEEL / ALLOY STEEL

RATING : PN 40/ PN 64

SIZE : 15 MM TO 300 MM

CAST IRON

RATING : PN 10/ PN 16

SIZE : 15 MM TO 250 MM



NON RETURN VALVE



**BS 6755 / BS 1868
ASME B 16.34 / API 6D**

STAINLESS STEEL (BAR STOCK)
RATING : 150#/ 300 #
SIZE : 8 MM TO 100.MM
FORGED CARBON STEEL/S. STEEL
RATING: 150#/ 300 #/ 800 #/ 1500 #
SIZE : 15 MM TO 400 MM
CAST CARBON STEEL/S. STEEL, ALLOY STEEL
RATING : 150#/ 300 #/ 600 #/ 900 #
SIZE : 15 MM TO 400 MM
CAST IRON
RATING : 125/150#
SIZE : 25 MM TO 600 MM

SPHERICAL DISC VALVE



BODY & DISC : CF8/CF8MIC.I. / WCB
SEAT : PTFE (Available EPDM Metal to Metal)
GLAND : PTFE
BEARING : PTFE
OPER. TEMP. : -50°C to 38°C -50°C to 220°C
(Soft Seat) -50°C to 600°C (M to M)
HANDLE : M.S./S. STEEL
PLATE MOUNTING : NAMUR/ STANDARD
OPERATION : HAND LEVER TYPE WORM GEAR BOX
TYPE PNEUMATIC ACTUATED
ELECTRICAL ACTUATED
SIZE : 40 MM TO 900 MM

DIN GLOBE VALVE



**BS 6755/ BS 1873 / ASME B 16.34/ DIN 3356
CAST CARBON STEEL/S. STEEL**
RATING : PN40/PN 64
SIZE : 25 MM TO 300 MM
DESIGN STD : BS 1873 / DIN 3356
TEST (INSPECTION) STD : BS 6755
CAST IRON
RATING : PN 10/ PN 16
SIZE : 15 MM TO 250 MM



OUR BRANDS



EXCLUSIVE DISTRIBUTORS FOR

TruX



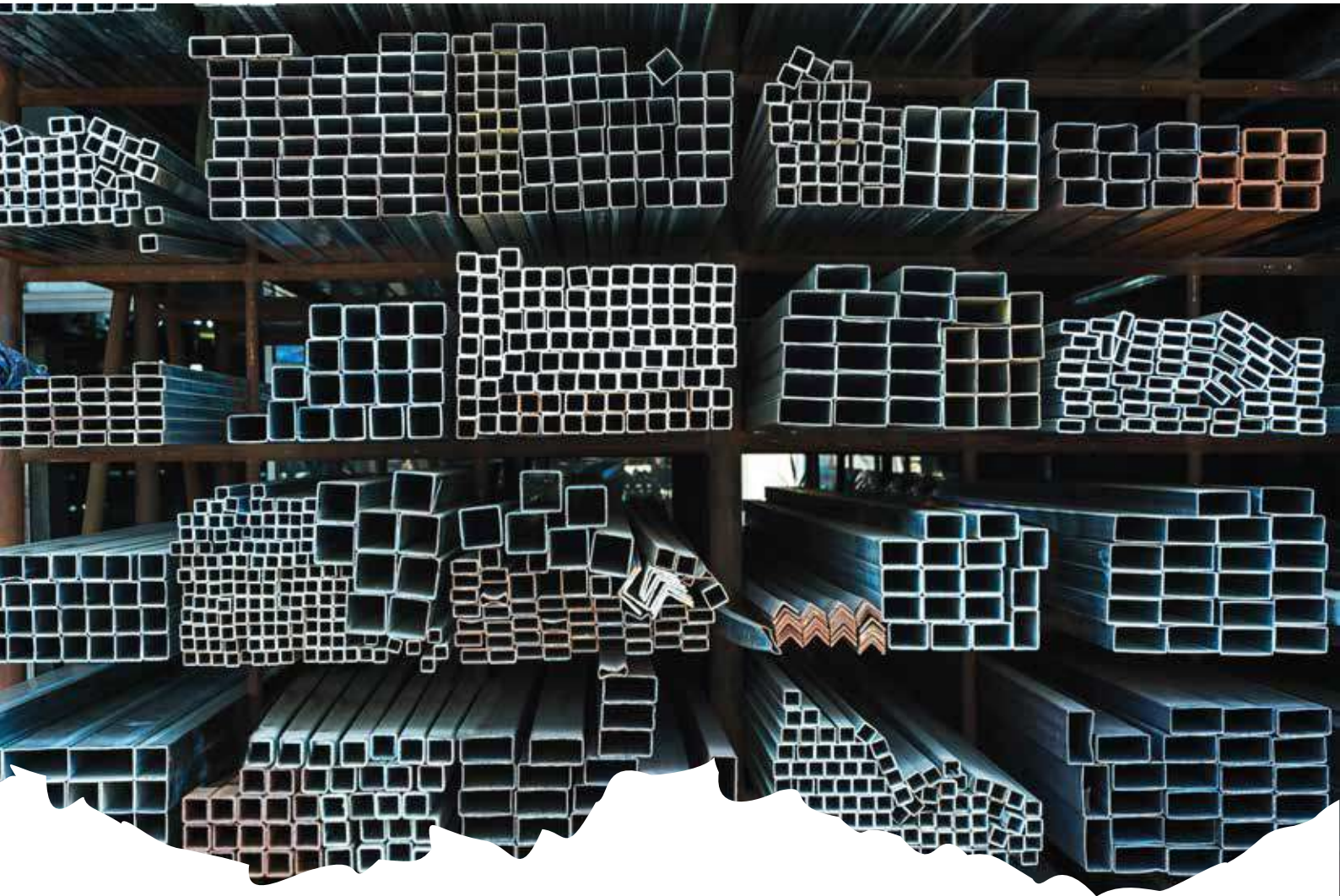

**PHARMACY
INDUSTRIES**



CEMENT PLANT



POWER PLANT



REFINERY PLANT



**OIL & GAS
INDUSTRIES**



**SUGAR
INDUSTRIES**



**FOOD
INDUSTRIES**



**IRON & STEEL
PLANT**



**FERTILIZER
INDUSTRIES**



SOLAR ENERGY



**TEXTILE
INDUSTRIES**



**PAPER
INDUSTRIES**



**CHEMICAL
INDUSTRIES**



**DAIRY
INDUSTRIES**



**AUTOMOBILE
INDUSTRIES**



**BEVERAGE
INDUSTRIES**

ADDRESS :

PLOT NO.18B, BLOCK D
EXPANSION IDA,
AUTONAGAR
VISAKHAPATNAM -530012

SG | 
ENTERPRISES

8897428618, 8074719977

info@sgpipes.in | sgpipes@gmail.com | www.sgpipes.in